

COMFORT AND PERFORMANCE
SHORTHANDED EASE OF USE
SHIPMAN 80
PILOTHOUSE



SHIPMAN 80 OFFERS A NEW AND UNIQUE BLEND OF CONVENIENT COMFORT AND SAILING PLEASURE, ENABLED BY CARBON-EPOXY TECHNOLOGY AND SUPERIOR DESIGN. THERE IS UNMATCHED EASE OF COCKPIT-TO-SEA AND COCKPIT-TO-ACCOMMODATION COMMUNICATION; LIGHT, VISION AND FRIENDLINESS OF HER PILOTHOUSE INTERIOR, WITH OWNER'S SPACE AND COMFORT OF A MUCH BIGGER BOAT – ALL IN A 30-TON LIGHT-DISPLACEMENT HULL BASED ON LATEST TANK-TESTING DEVELOPMENTS.

With her hydraulic lifting keel, twin rudder configuration and no-runners carbon rig, the Shipman 80 will be the ideal short-handed performance cruiser for the world's oceans.

SHIPMAN 80

GENERAL OVERVIEW

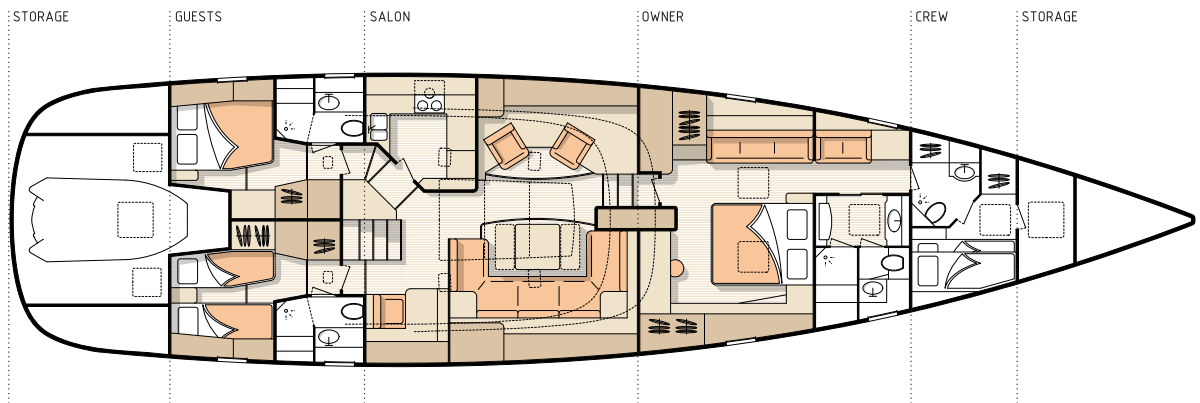

24 23 22 21 20 19 18 17 16 15 14 13 12 11 10 9 8 7 6 5 4 3 2 1 0 meters

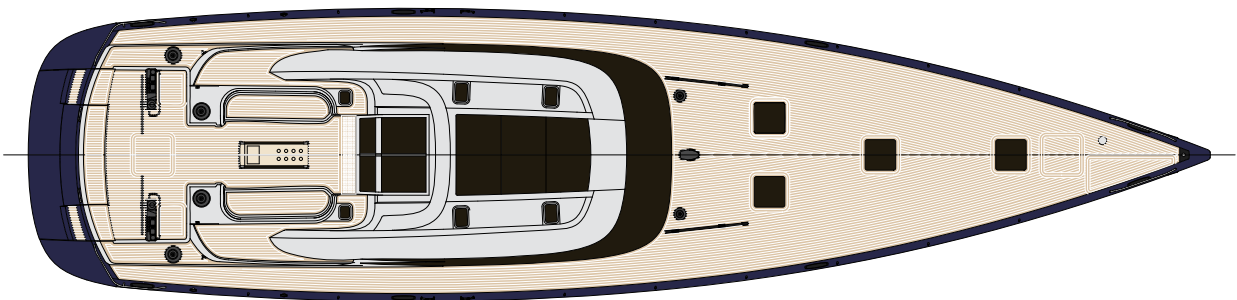

SHIPMAN 80

SAIL PLAN

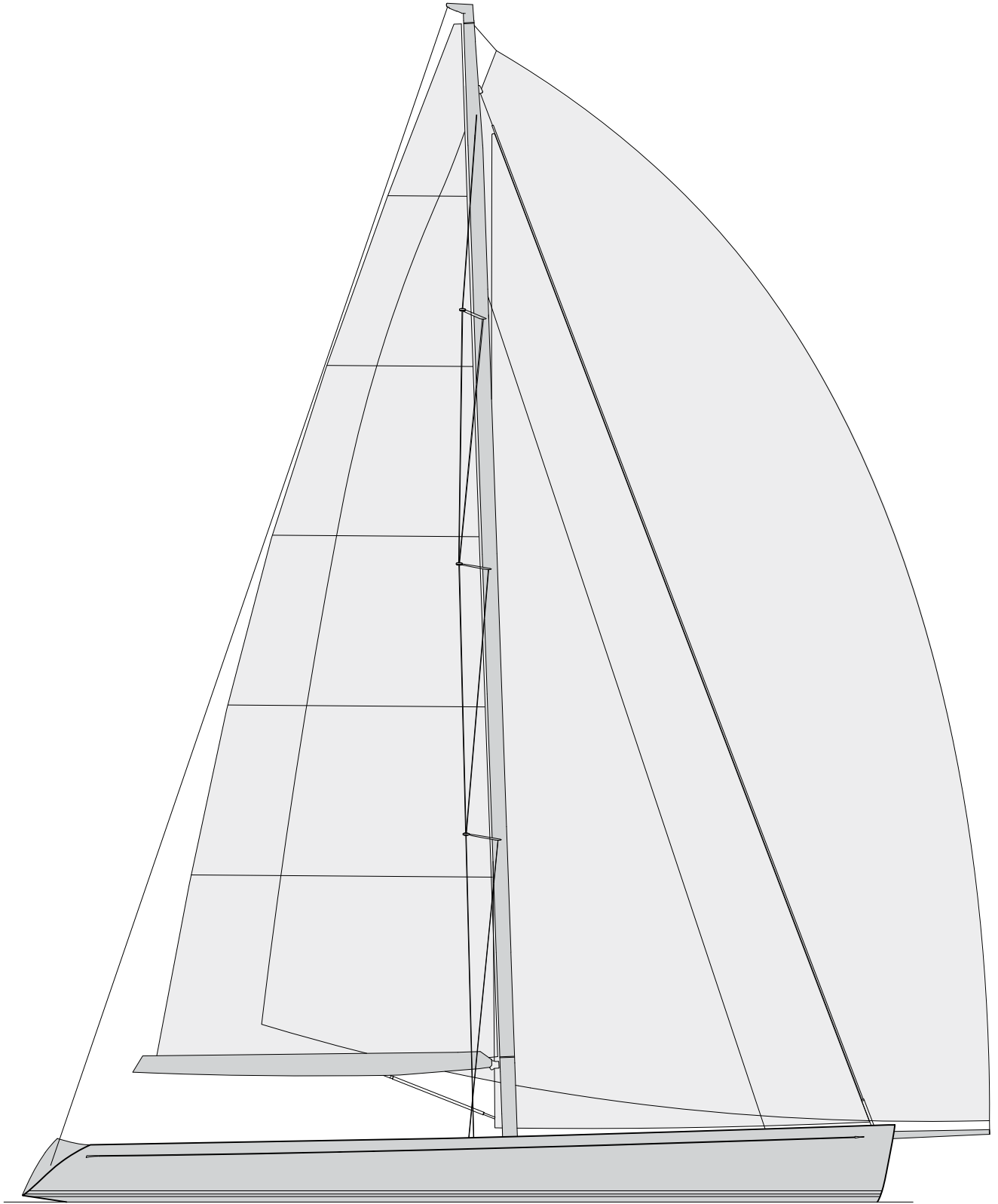

24 23 22 21 20 19 18 17 16 15 14 13 12 11 10 9 8 7 6 5 4 3 2 1 0 meters

SHIPMAN 80

MAIN DIMENSIONS VELOCITY PREDICTION PROGRAMME

MAIN DIMENSIONS

LOA (hull)	23.98 m
LWL	21.84 m
B max	5.95 m
BWL	5.00 m
Draft optional lifting keel (up-down)	2.50-4.00 m
Ballast	appr. 11000 kg
DSPL empty (ex options)	appr. 31500 kg
I	28.65 m
J	9.77 m
P	28.40 m
E	9.50 m
Mainsail full batten	154 sqm
Jib 106%	142 sqm
Flying code "o" (on bowsprit)	330 sqm
Spinnaker (asymmetrical) on bowsprit	490 sqm
Cabins	4
Berths	8
Diesel	2000 l
Water	1200 l
Engine	VW Marine Diesel 230 HP
Cat. CE	A
Design	J&J design
Interior styling and design	Dick Young
Builder	Seaway

VPP DIAGRAM

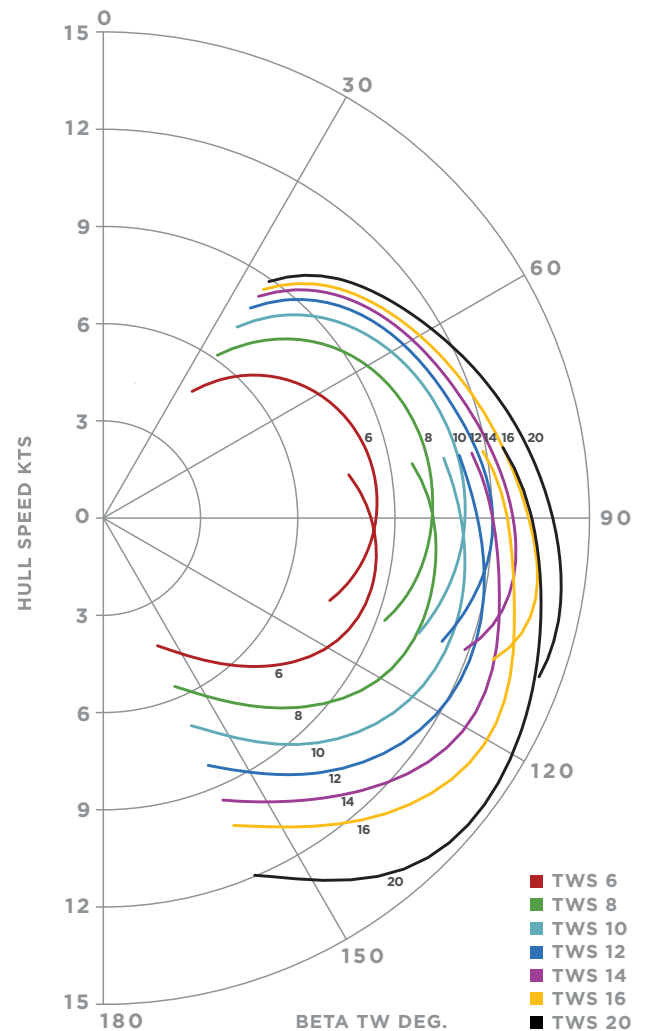

VPP (VELOCITY PREDICTION PROGRAMME)
 These so called Target Speeds allow for optimisation of sail and boat trim while helping to understand the potential of the boat in certain conditions.